

a 46-36

№ 5728

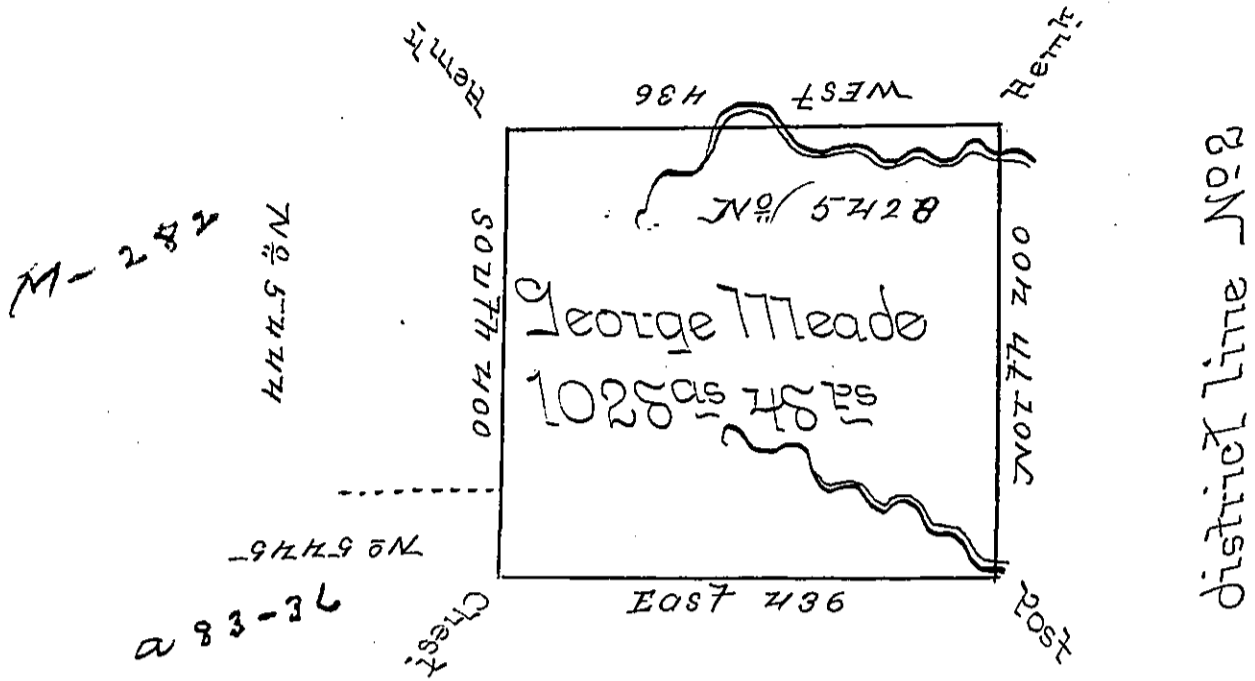

№ 5727

M-273

A-46-39

Situate on the Waters of Summerhollow Creek in North County containing 1025 Acres 45 Perches and the usual Allowance for Roads Surveyed May 14th 1894 for George Meade in pursuance of a Warrant № 5725 dated 8th March 1894

John Conant D.S.

Daniel Bradford D.S.

IN TESTIMONY that the above is a copy of the original remaining on file in the Department of Internal Affairs of Pennsylvania, made conformably to an Act of Assembly approved the 16th day of February, 1833, I have hereunto set my Hand and caused the Seal of said Department to be affixed at Harrisburg, this first day of November 1898.

James W. Latta
Secretary of Internal Affairs.